

**PA6**  
PURE NYLON

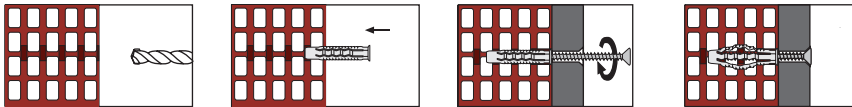

- High hold performance thanks to the wings that open in four different directions
- High-grade nylon material
- Flexible structure
- Upper wings that prevent twisting



Product	Art. No.	Hole Diameter	Anchor Length	Screw Diameter	Qty Per Box	Qty Per Carton
GL 5	41211	5	25	4	200	6400
GL 6	41212	6	30	4,5	200	6400
GL 6x45	41217	6	45	4,5	200	6400
GL 8	41213	8	40	5 - 6	100	3200
GL 8x50	41218	8	50	5 - 6	75	2400
GL 10	41214	10	50	6 - 7	50	1600
GL 12	41215	12	60	8	25	800
GL 14	41216	14	70	10	25	800

## GL

Universal Nylon Plug  
Four-Sided Expansion

### Main Material

- Concrete
- Naturel Stone
- Hollow Brick
- Solid Brick
- Bims
- Asphalt
- Drywalls
- Aerated Concrete

### Application Field

- Furnitures
- Shelves
- Frames
- Lamps
- Electrical Equipment
- Bathroom Accessories
- Assembly Of Various Lightweight Loads

## GL

Application

## GL

Plug

## Complementary Products



page 99



page 100



Chemical Anchors

Heavy Duty Anchors

General Purpose Fasteners

Frame Anchors

Aerated Concrete Anchors

Drywall Anchors

Nailing Systems

Insulation Anchors

Screws

Drill Bits

Scaffold Fasteners

Solar System Fasteners

Special Fixing





Chemical Anchors

## GL

Plug Bulk Package

Heavy Duty Anchors

General Purpose Fasteners

Frame Anchors

## GL

Countersunk Screw

Aerated Concrete Anchors

Drywall Anchors

Nailing Systems

Insulation Anchors

## GL

Countersunk

Stainless Steel Screw

Screws

Drill Bits

Scaffold Fasteners

Solar System Fasteners

Special Fixing



Product	Art. No.	Hole Diameter	Anchor Length	Screw Diameter	Qty Per Package
<b>GL 5</b>	41221	5	25	4	4000
<b>GL 6</b>	41222	6	30	4,5	4000
<b>GL 6</b>	41227	6	45	4,5	4000
<b>GL 8</b>	41223	8	40	5 - 6	2000
<b>GL 8x50</b>	41228	8	50	5 - 6	2000
<b>GL 10</b>	41224	10	50	6 - 7	1000
<b>GL 12</b>	41225	12	60	8	500
<b>GL 14</b>	41226	14	70	10	500



Product	Art. No.	Hole Diameter	Anchor Length	Screw	Qty Per Box	Qty Per Carton
<b>GL 5</b>	41241	5	25	4 x 30	100	3200
<b>GL 6</b>	41242	6	30	4,5 x 40	100	3200
<b>GL 8</b>	41243	8	40	5 x 50	50	1600
<b>GL 10</b>	41244	10	50	6 x 60	25	800



Product	Art. No.	Hole Diameter	Anchor Length	Screw	Qty Per Box	Qty Per Carton
<b>GL 5</b>	41251	5	25	4 x 30	100	3200
<b>GL 6</b>	41252	6	30	4,5 x 40	100	3200
<b>GL 8</b>	41253	8	40	5 x 50	50	1600
<b>GL 10</b>	41254	10	50	6 x 60	25	800

## Complementary Products



page 99



page 100