

- Used in connections with rods and bolts.
- The plug prevents dust from entering the anchor.
- Depth adjustment can be made for the connected rods

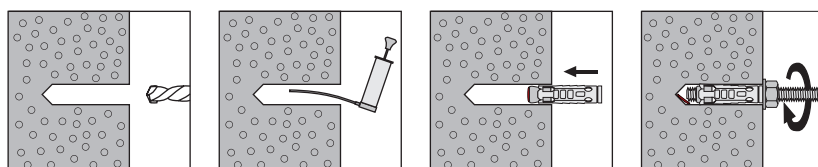

Product	Art. No.	Hole Diameter	Anchor Length	Qty Per Box	Qty Per Carton
<b>SMZ M6</b>	55001	10	46	180	2160
<b>SMZ M8</b>	55002	12	50	100	1200
<b>SMZ M10</b>	55003	15	55	60	720
<b>SMZ M12</b>	55004	18	80	40	480
<b>SMZ M16</b>	55005	24	90	20	240

Product	Art. No.	Hole Diameter	Anchor Length	Qty Per Box	Qty Per Carton
<b>SMZ-A2 M6</b>	55011	10	46	180	2160
<b>SMZ-A2 M8</b>	55012	12	50	100	1200
<b>SMZ-A2 M10</b>	55013	15	55	60	720
<b>SMZ-A2 M12</b>	55014	18	80	40	480
<b>SMZ-A2 M16</b>	55015	24	90	20	240

## SMZ

One Piece Anchor

### Main Material

- Concrete
- Hard Naturel Stone

### Application Field

- Mechanical Installation
- Electrical Installation
- Rod and Bolt Connections

## SMZ

Application

## SMZ

Zinc Plated

## SMZ-A2

Stainless Steel

## Complementary Products



page 99



page 35



page 35



Chemical Anchors

Heavy Duty Anchors

General Purpose Fasteners

Frame Anchors

Aerated Concrete Anchors

Drywall Anchors

Nailing Systems

Insulation Anchors

Screws

Drill Bits

Scaffold Fasteners

Solar System Fasteners

Special Fixing

